

*CITY OF CARPINTERIA*  
***General Plan/LCP Update***  
*General Plan Committee Meeting - March 19, 2017*



# Project Status

- ▶ Additional Grant Funding
- ▶ Community Health & General Plan Survey - until May 31
  - ▶ <http://www.carpinteria.ca.us/communitydev/GeneralPlanUpdate.shtml>
- ▶ Healthy Community Element
  - ▶ Incorporating feedback from public workshops & survey data
- ▶ Draft Sea Level Rise Vulnerability Assessment
  - ▶ Public Review Fall 2018
- ▶ Updates to Existing Elements
  - ▶ Focus of this meeting

# General Plan/LCP Changes

- ▶ Format
- ▶ Office of Planning & Research (OPR) Guidelines
- ▶ Local Coastal Program Update Guide - California Coastal Commission
- ▶ Policies & Descriptive Text
  - ▶ Strengthen language
  - ▶ Ensure policies are feasible
  - ▶ Reduce redundancy
  - ▶ Move content to most relevant element

# Noise Element

## INTRODUCTION

Introduction to element & purpose

### Issue Areas

Description of issue areas

## HEADING

### Subheading 1

Text

### Subheading 2

Text

**Objective N-1: Objective text**

### Policy:

**N-1a.** Policy text

### ***Implementation Measures:***

*Subheading 3:*

1. *Implementation Measure Text*

### Relevant Legislation

Text

### Definitions

Text

# OPR Guidelines for Noise Element

Statutory Citation	Brief Description of Requirement
Gov. Code § 65302(f)(1)	(1) A noise element that shall identify and appraise noise problems in the community and shall analyze and quantify, to the extent practicable, as determined by the legislative body, current and projected noise levels for all of the following sources: (A) Highways and freeways.
Gov. Code § 65302 (f)(1)(B)	(B) Primary arterials and major local streets.
Gov. Code § 65302 (f)(1)(C)	(C) Passenger and freight online railroad operations and ground rapid transit systems.
Gov. Code §65302 (f)(1)(D)	(D) Commercial, general aviation, heliport, helistop, and military airport operations, aircraft overflights, jet engine test stands, and all other ground facilities and maintenance functions related to airport operation.
Gov. Code § 65302(f)(1)(E)	(E) Local industrial plants, including, but not limited to, railroad classification yards
Gov. Code § 65302 (f)(1)(F)	(F) Other ground stationary noise sources, including, but not limited to, military installations, identified by local agencies as contributing to the community noise environment
Gov. Code § 65302(f)(2)	(2) Noise contours shall be shown for all of these sources and stated in terms of community noise equivalent level (CNEL) or day-night average level (Ldn). The noise contours shall be prepared on the basis of noise monitoring or following generally accepted noise modeling techniques for the various sources identified in paragraphs (1) to (6), inclusive.
Gov. Code § 65302(f)(3)	(3) The noise contours shall be used as a guide for establishing a pattern of land uses in the land use element that minimizes the exposure of community residents to excessive noise.
Gov. Code § 65302(f)(4)	(4) The noise element shall include implementation measures and possible solutions that address existing and foreseeable noise problems, if any. The adopted noise element shall serve as a guideline for compliance with the state's noise insulation standards.

# Noise Contour Map

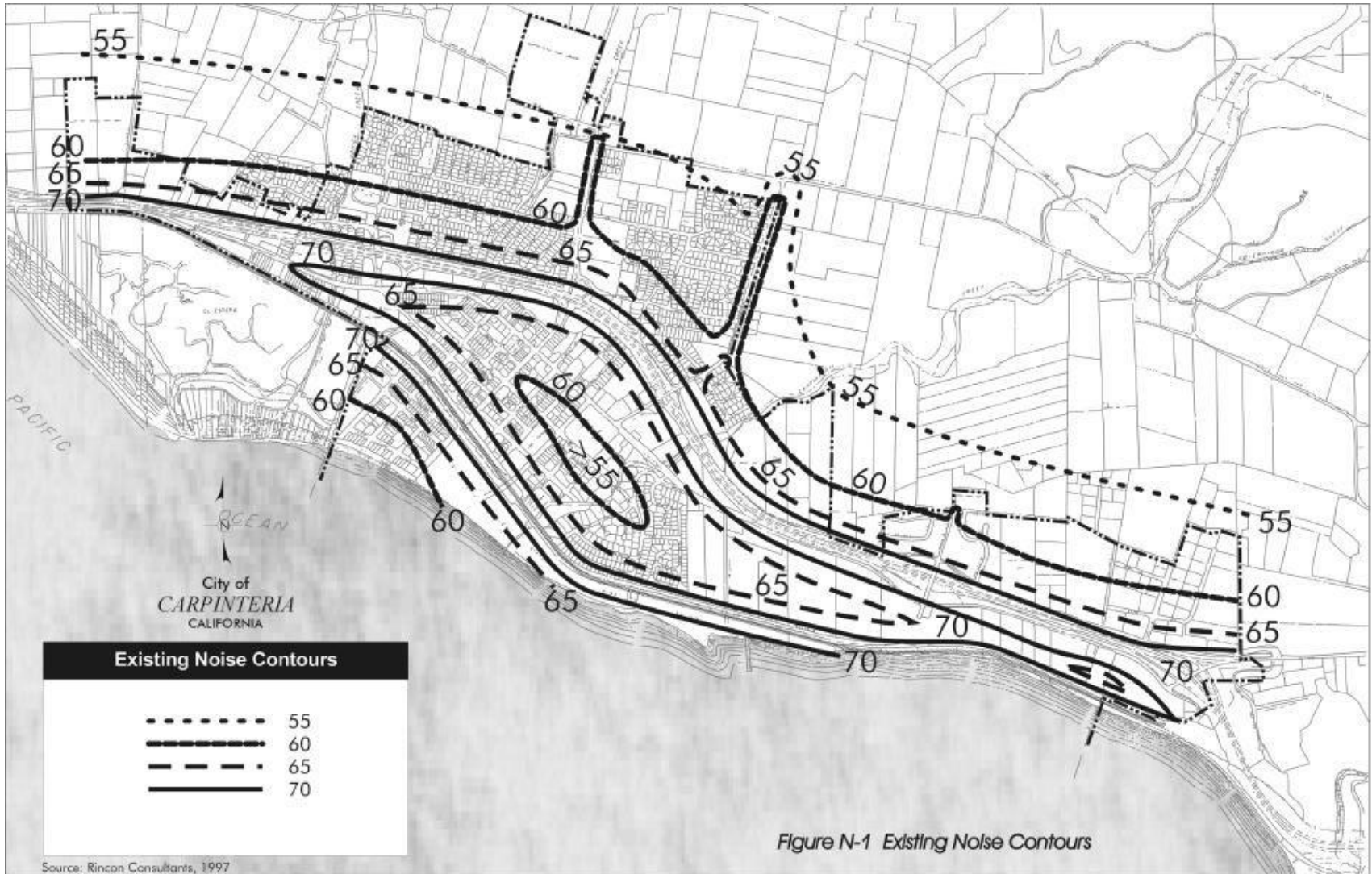

# New Objectives & Policies

**Objective N-1:** The City shall incorporate noise and vibration considerations into planning decisions in order to maintain or achieve a compatible noise environment for all land uses within the community.

## **Policy:**

**N-1a.** The City shall use Figures N-1, N-2, and N-3 to determine whether new development has the potential to result in noise/land use conflicts.

# Objectives & Policies - Strengthen Language

**Objective N-21:** ~~The City shall consider noise impacts from rail or U.S. Highway 101 traffic on residential and other noise sensitive land uses. The City will minimize noise impacts of Highway 101 traffic on residential and other sensitive land uses.~~¶

## **Policies:**¶

**N-21a.** The City ~~will~~ shall plan noise-compatible land uses or design developments with noise attenuation features near ~~or adjacent to transportation corridors~~ Highway 101.¶

**N-2b1b.** The City ~~will~~ shall continue to collaborate and cooperate with Caltrans to landscape or install mitigation elements along U.S. Highway 101 adjacent to residential or noise sensitive uses to reduce noise impacts. Any noise attenuation features should adhere to relevant policies in the Ccity's Community Design Element.¶



# Remove or consolidate redundant policies

## Policies:

**N-1c.** The City will work with local and regional transit agencies and businesses to provide public transit services that reduce traffic and minimize traffic's contribution to the noise environment.

**N-3c.** The City will work with local and regional transit agencies and businesses to provide public transit services that reduce traffic and associated noise.

R  
e  
d  
u  
n  
d  
a  
n  
t

## Implementation Measures:

*The City will designate truck routes, limiting trucking through residential areas.*

# Enforceable Policies - Community Input

## Policies:

**N-5b.** The City shall limit the use of motorized landscaping equipment, parking lot sweepers, or other high- noise equipment to between the hours of **X:00 AM to X:00 PM** on **[WEEKENDS, HOLIDAYS]** if their activity will result in noise that adversely affects sensitive land uses.

**N-5c.** The City shall require that the hours of truck deliveries to industrial and commercial properties adjacent to noise sensitive land uses shall be limited to the hours of **X:00 AM to X:00 PM** on **[WEEKDAYS, WEEKENDS, HOLIDAYS]**.

# Next Steps

- ▶ Update Noise Contours
  - ▶ Summer 2018
- ▶ Next meeting
  - ▶ April 16, 2018 - Project Status Update (City staff only)
- ▶ Website
  - ▶ <http://www.carpinteria.ca.us/communitydev/GeneralPlanUpdate.shtml>
- ▶ Survey
  - ▶ <http://www.carpinteria.ca.us/communitydev/GeneralPlanUpdate.shtml>